



Dr. Shureen Faris Abd Shukor

Qualification:

PhD (Restorative Green Outdoor Environment), University of Copenhagen, Denmark
Master of Science (Landscape Studies), Universiti Putra Malaysia
Bachelor of Landscape Architecture, Universiti Teknologi Malaysia
Diploma in Landscape Design, Institut Teknologi MARA

Working Experience:

Faculty of Design and Architecture, Universiti Putra Malaysia
Island and Peninsular Group, Setiawangsa, Kuala Lumpur
EDC Landscape Consultant, Pandan Jaya, Kuala Lumpur

Field of Specialization:

Health and Design

Research Areas of Interest:

Landscape Architecture, Therapeutic Landscape, Restorative Green Outdoor Environment for Healthcare Facilities & Design for Special Needs' Population



+603 8946 4046 / +6014 6463 760



Department of Landscape Architecture, Faculty of Design and Architecture, UPM



shureen@upm.edu.my / shureenf@yahoo.com

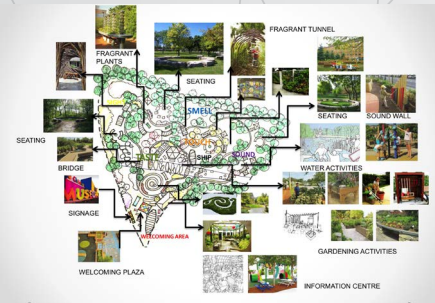

Dr. Shureen Faris Abdul Shukor is a Landscape Architect and a Senior Lecturer at the Department of Landscape Architecture, Faculty of Design and Architecture, Universiti Putra Malaysia. She holds a PhD degree from the University of Copenhagen. Her PhD research focused on the design of green outdoor environment in health care facilities. Her other qualifications are Diploma in Landscape Design from UiTM Shah Alam (1993), Bachelor in Landscape Architecture from UTM Skudai (1995) and Master in Landscape Studies (2008) from UPM, Serdang.

Upon completion of her degree in 1995, Shureen worked at EDC Landscape Consultant as a Landscape Architect until 1997. From 1997 to 2001, she was employed at Island and Peninsular Group as a Landscape Architect, overseeing projects such as Kinrara Golf Club, Bayu Lake Homes and Ampang

971. While doing her PhD in Copenhagen, Shureen was appointed as a scientific advisor by ArchiMed, a hospital design consultant based in Copenhagen from 2011 to 2013.

Shureen is currently involved with advisory work for projects with therapeutic benefits such as the UPM Teaching Hospital, Sensory Garden for Children, Horticulture Therapy for the elderly and the establishment of the first Landscape Therapy Lab in Malaysia. She is also the Head of the 'Tropical Health and Design' Research Team at the Faculty of Design and Architecture, UPM. She was a writer for the monthly landscape and décor magazine, Anjung Seri from 2006 to 2013. Shureen is currently active as a regular contributor in a landscape column, appearing fortnightly in the Malay newspaper Kosmo.